



8478 S/62 BALL BEARING EXTRACTOR SET

ITEM NO. 8478-0001

- For ISO 6000 to ISO 6406 deep groove ball bearings.
- Supplied in plast case.
- 62 tools.

5704196 036410

7,5 KG 1



CONTENT:

QTY.	DESCRIPTION	SIZE
3	Ball bearing extractors	
4	Pulling hooks for ISO 6000-6003, 6200	160 mm
4	Pulling hooks for ISO 6004-6006, 6201-6203, 6300	160 mm
4	Pulling hooks for ISO 6204-6205, 6301-6303	180 mm
4	Pulling hooks for ISO 6007-6013	196 mm
4	Pulling hooks for ISO 6011-6012, 6206-6207, 6304-6306	196 mm
4	Pulling hooks for ISO 6208-6210, 6307, 6403, 6407	237 mm
4	Pulling hooks for ISO 6211-6212, 630-6311, 6404-6408	239 mm
22	Support rings	
6	Accessories	

8479 BALL BEARING PULLER SET

ITEM NO. 8479-0001

- For ISO 6004-6010, 6200-6205, 6300-6304 and 61812-61816 bearings.
- Supplied in plast case.
- 14 tools.

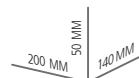

5704196 036427

0,9 KG 1



CONTENT:

QTY.	DESCRIPTION	MODEL/SIZE
1	Pulling device	8479
3	Extension sets	40 - 95 - 105 mm
3	Adaptor sets	Ø 5,3 x 3,2 - Ø 6 x 4,1 - Ø 8 x 5,1 mm



8480 ADJUSTABLE BALL JOINT EXTRACTOR

- For extracting ball pins when dismantling ball joints, trackrod ends on trackrods.
- Surface: Chrome plated. Burnished spindle.
- Material: Chrome-vanadium steel.

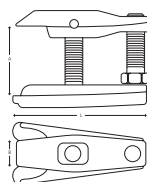

ITEM NO.

5704196+

A	B	L	KG			
8480-0050	036434	50	18-22	100	0,7	1
8480-0095	036441	95	28-32	157	2,6	1
8480-0120	036458	120	32-36	191	4,9	1

8481 A ADJUSTABLE BALL JOINT EXTRACTORS LEVER

- For extracting ball pins when dismantling ball joints, trackrod ends on trackrods.
- Surface: Chrome plated. Burnished spindle.
- Material: Chrome-vanadium steel.

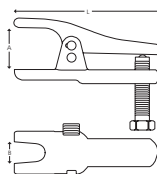

ITEM NO.

5704196+

A	B	L	KG			
8481-0056	036465	56	20-24	161	1,2	1

8481 B ADJUSTABLE BALL JOINT EXTRACTORS LEVER

- For extracting ball pins when dismantling ball joints, trackrod ends on trackrods.
- Surface: Chrome plated. Burnished spindle.
- Material: Chrome-vanadium steel.

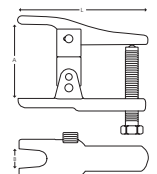

ITEM NO.

5704196+

A	B	L	KG			
8481-0090	036472	90	20-24	161	1,7	1